

**Step 1.** Scrape the top of the tile to remove any burrs.

**Step 2.** Pre-drill holes in the bond beam. Insert steel and bend it over. Tie the steel together around the entire pool.

*Note:* During cold weather it may be necessary to warm the tile prior to sticking the form.

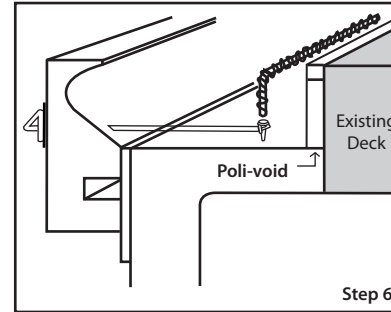

**Step 6.** Apply spray adhesive to the existing deck. Let stand 1 minute. With the perforated tear strip up, press the Poli-Void level to the existing deck.

*Note:* While pouring tap the form to release air bubbles. This will help prevent honeycombing.

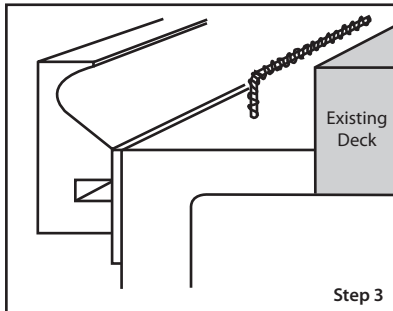

**Step 3.** Peel the paper from the double-faced tape one foot at a time, sticking the form to the tile with the lower edge of the form profile, even with the top of the tile.

**Step 4.** Drive nails into bond beam approximately 8 inches back from the tile 14 inches apart.

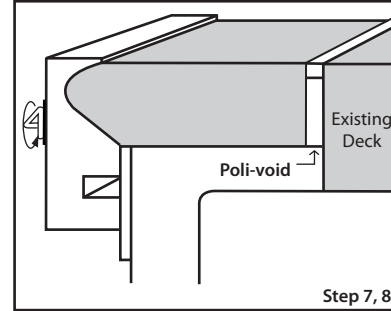

**Step 7.** Finish the top of the deck.

**Step 8.** When the concrete will support its own weight, the forms can be removed. To remove the forms, twist the tie wire head, it will break the tie wire inside the concrete. Then pull the form away exposing the face for the finish.

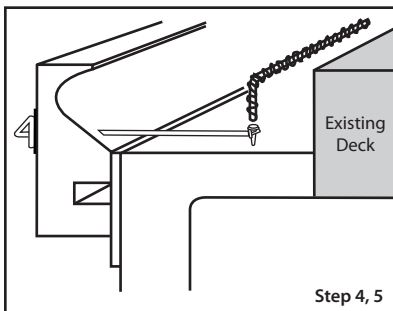

**Step 5.** Place the plastic washer (provided) on the tie wire. Push the tie wire through the form, even with the top of the tile. Wrap the end of the tie wire around the concrete nail, applying slight pressure.

**Step 9.** Let the concrete cure for about two weeks.

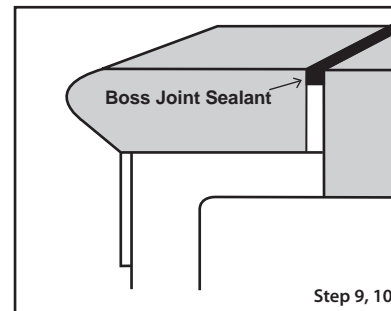

**Step 10.** Remove the Poli-Void tear strip. Pour the Boss Joint Sealant in the void. (Follow the instructions on the Boss Joint Sealant tube).