

STEP LEDGER

STEGMEIER[®]
LLC

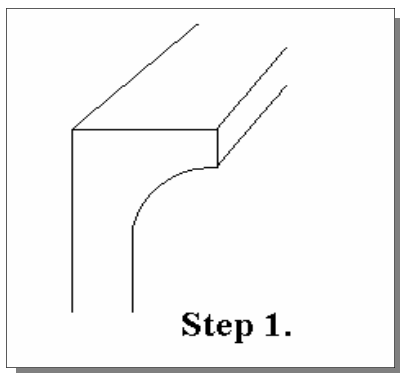

Step 1. Level the step ledger with the highest point of the bond beam.

Step 2. Using the supplied nails, Attach step ledger to the bond beam.

Note: The nail must go through the fiberglass tape. Slightly pull on the form ensure it is firmly attached to the pool wall.

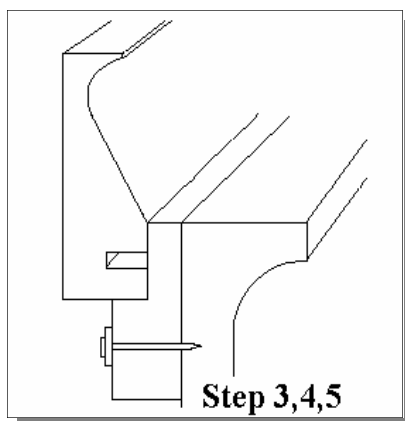
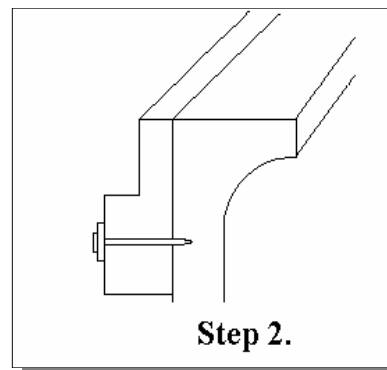

Step 3. Peel the paper from the double-faced tape (one foot at a time). Press the form to the ledger as illustrated.

Step 4. Lay a bond breaker down on the bond beam. The bond breaker will separate the concrete from the beam, so if the soil shifts, the tile won't be damaged. For a bond breaker you can use 15 lb. felt.

Structural Considerations: If the installation is a coping pour, DO NOT apply a bond breaker as it is necessary to adhere the concrete to the bond beam.

Step 5. Reference Tie Wire System instructions to complete installation.